

# RABBETING

## RABBET BITS

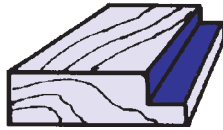
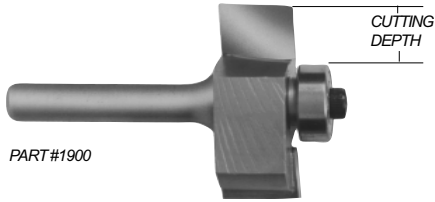

Part Number	Large Diameter	Cutting Length	Cutting Depth	Bearing Number
<b>1/4" SHANK</b>				
1900	1 1/4"	1/2"	3/8"	B3
1951	1 3/8"	1/2"	1/2"	B2
<b>1/2" SHANK</b>				
1901	1 1/4"	1/2"	3/8"	B3
1954	1 3/8"	1/2"	1/2"	B2
1959	1 7/8"	1"	3/4"	B2

## SLOTING & RABBETING

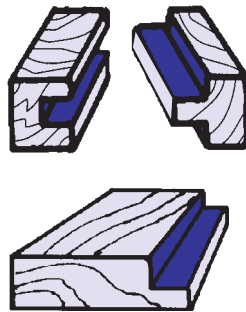
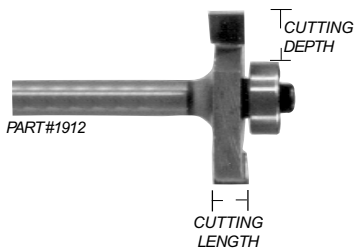

Part Number	Large Diameter	Cutting Length	Cutting Depth	Overall Length
<b>1/4" SHANK</b>				
1904	1 1/4"	1/8"	3/8"	2"
*1908	1 1/2"	5/32"	1/2"	1 3/4"
1912	1 1/4"	1/4"	3/8"	2"
1916	1 1/4"	3/8"	3/8"	2"
1920	1 1/2"	1/2"	1/2"	2"
<b>1/2" SHANK</b>				
1906	1 1/4"	1/8"	3/8"	2"
*1910	1 1/2"	5/32"	1/2"	2"
1914	1 1/4"	1/4"	3/8"	2"
1918	1 1/4"	3/8"	3/8"	2 1/8"
1922	1 1/2"	1/2"	1/2"	2 1/4"
1924	1 1/4"	3/4"	3/8"	2 1/2"

B3 Bearing supplied.

\*Proper Size for Biscuit Joining

BB501 - Bearing Kit with Wrench (see pg. 34). Increase the versatility of your Rabbeting Bits by simply changing the bearing size to vary your cutting depth. This set allows 1/4", 5/16", 3/8", & 7/16" cutting depth on all 1 1/4" bits or 3/8", 7/16", 1/2", & 9/16" cutting depth on all 1 1/2" bits.

## BISCUIT JOINING KIT

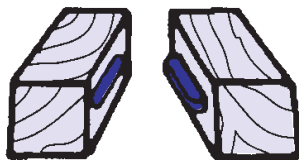

This kit contains our 5/32" Rabbeting Bit with 1/2" B3 bearing for cutting slots to fit #20 Biscuits. Also includes alternate bearings B14 and B15 to cut slots for #0 and #10 Biscuits. Hex Wrench included.

Part Number	Description
1940	1/4" shank kit
1945	1/2" shank kit

## MULTI RABBET SET

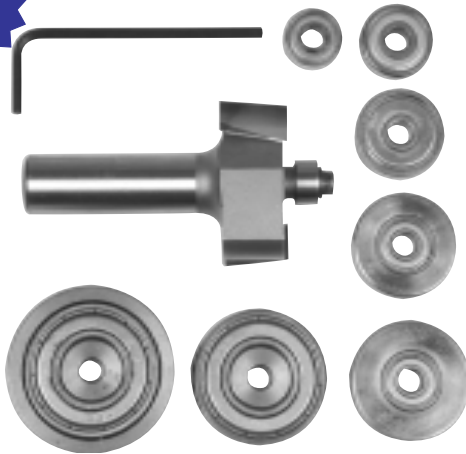

Change your Rabbet depth by changing the bearing! Set includes all eight bearings to make each of the cuts shown. Hex Wrench included.

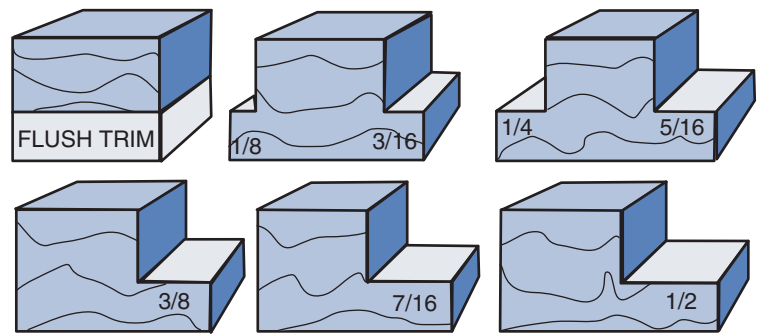

Set Number	Large Diameter	Cutting Length	Description
1952	1 3/8"	1/2"	1/4" Shank Set
1955	1 3/8"	1/2"	1/2" Shank Set

Sets are organized and protected in 4" x 4" x 3" Box.

## DEEP MULTI RABBET SET

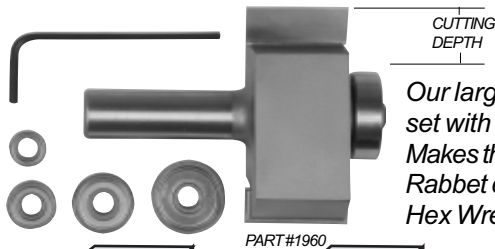

Our largest Rabbet Bit in a set with five bearings. Makes those extra deep Rabbet cuts as shown. Hex Wrench included.

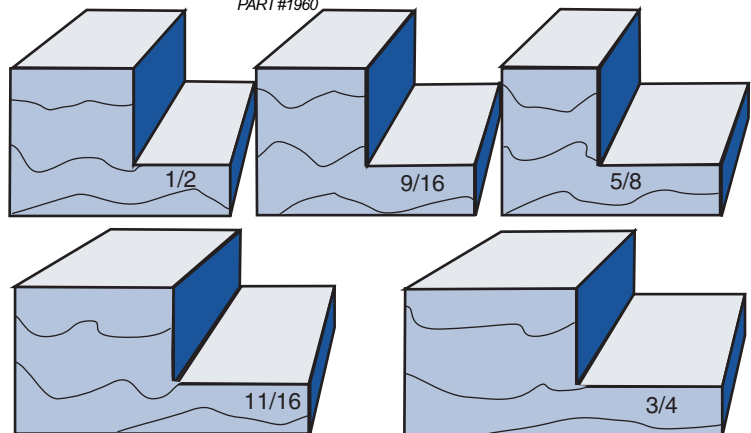

Set Number	Large Diameter	Cutting Length	Description
1960	1 7/8"	1"	1/2" Shank Set

Sets are organized and protected in 4" x 4" x 3" Box.